

# L SERIES PUMP SERVICE PARTS

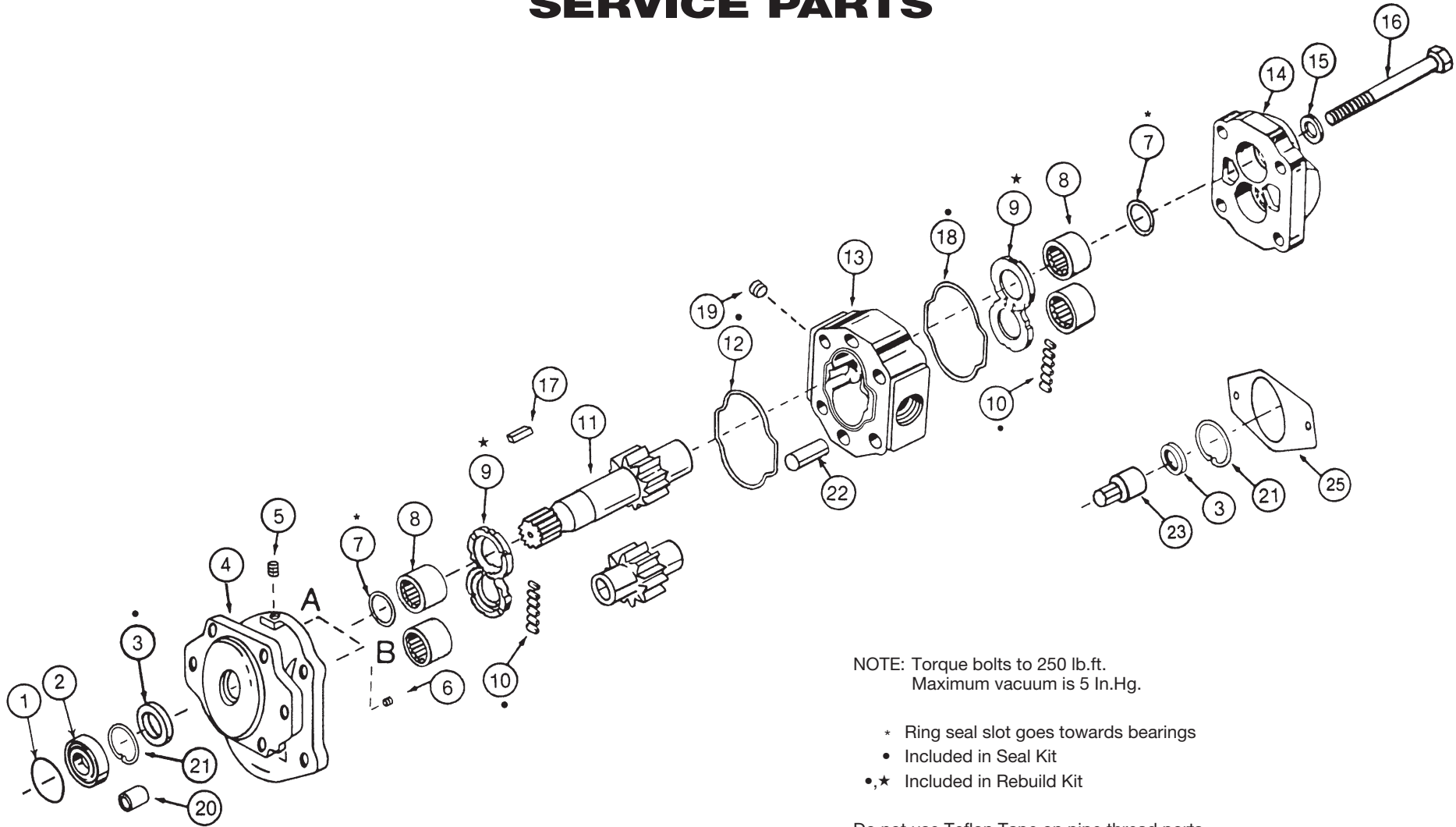

NOTE: Torque bolts to 250 lb.ft.  
Maximum vacuum is 5 In.Hg.

- \* Ring seal slot goes towards bearings
- Included in Seal Kit
- ,\* Included in Rebuild Kit

Do not use Teflon Tape on pipe thread ports.



**Muncie®  
Power  
Products**

SP89-04 (Rev. 10-04) Printed in the U.S.A.  
© Muncie Power Products, Inc. 2004

**Muncie Power Products, Inc.** Member of the Interpump Hydraulics Group  
General Offices and Distribution Center • P.O. Box 548 • Muncie, IN 47308-0548  
(765) 284-7721 • FAX (765) 284-6991 • E-mail info@munciepower.com  
Web site <http://www.munciepower.com>

Drive Products, Inc., Toronto, Exclusive Agents for Canada, ISO Certified by an Accredited Registrar



# L SERIES PUMP SERVICE PARTS

Item	Description	Qty	Muncie Number	Item	Description	Qty	Muncie Number
1	O.B. Snap Ring	1	PL-1001	13	Body (Pipe Ports)	1	
2	O.B. Bearing	1	PL-1002		14 GPM		PL-1025-14P
	Seal Retainer (without O.B. Bearing)	1	PE-1002D		16 GPM		PL-1025-16P
3	Shaft Seal	1	PL-1005		19 GPM		PL-1025-19P
4	Front Cover	1			23 GPM		PL-1025-23P
	SAE B Direct (Spline Shaft)		PL-1007-D		25 GPM		PL-1025-25P
	SAE B Direct (Rnd Shaft)		PL-1007-DOB		27 GPM		PL-1025-27P
	Remote Foot PAD		PL-1007-R		30 GPM		PL-1025-30P
	SAE C		PL-1007-DC		Body (ODT Ports)		
	SAE B 4-Bolt		PL-1007-K		14 GPM		PL-1025-14S
5	Pipe Plug	1	HHPP-4		16 GPM		PL-1025-16S
6	Check Assembly	2	PS-1010		19 GPM		PL-1025-19S
7	Ring Seal	2	PL-1008		23 GPM		PL-1025-23S
8	Bearings	4	PL-1013		25 GPM		PL-1025-25S
9	Wear Plates	2			27 GPM		PL-1025-27S
	Std		PL-1014		30 GPM		PL-1025-30S
10	Pocket Seal (12pcs)	1(3" strips)	PS-1009	15	Washer	4	PL-1029
11	Gear Sets	1		14	Rear Cover (NPT)	1	PL-1026P
	7/8-13T Spline				Rear Cover (ODT)	1	PL-1026S
	14		PL-1016S-14-2		Machined For RV (NPT)		PL-1026-RV
	16		PL-1016S-16-2		Machined For RV (ODT)		PL-1026-RVS
	19		PL-1016S-19-2		Rear Cover (Versatile)	1	PL-1026TV
	23		PL-1016S-23-2	16	Capscrew/Stud	2 or 4/2	
	25		PL-1016S-25-2		14 GPM		PL-1028-14/PL-1028-14S
	27		PL-1016S-27-2		16 GPM		PL-1028-16/PL-1028-16S
	30		PL-1016S-30-2		19 GPM		PL-1028-19/PL-1028-19S
	1 In. Round				23 GPM		PL-1028-23/PL-1028-23S
	14		PL-1016K-14-2		25 GPM		PL-1028-25/PL-1028-25S
	16		PL-1016K-16-2		27 GPM		PL-1028-27/PL-1028-27S
	19		PL-1016K-19-2		30 GPM		PL-1028-30/PL-1028-30S
	23		PL-1016K-23-2		N.S. Nut (direct only)		PE-1020
	25		PL-1016K-25-2		Capscrew (Versatile)		
	27		PL-1016K-27-2		14 GPM		PL-1028-294
	30		PL-1016K-30-2		16 GPM		PL-1028-341
	1 In. 15T Spline				19 GPM		PL-1028-295
	14		PL-1016S17-14-2		23 GPM		PL-1028-14
	16		PL-1016S17-16-2	17	Key	1	PS-1017
	19		PL-1016S17-19-2	18	Body Seal	1	
	23		PL-1016S17-23-2		Rear Cover		PL-1015
	25		PL-1016S17-25-2	19	Port Plug	2	
	27		PL-1016S17-27-2		1 Inch (NPT)		HHPP-16
	30		PL-1016S17-30-2		1-1/4 Inch (NPT)		HHPP-20
	1-1/4 In. Round				1-1/2 Inch (NPT)		HHPP-24
	23		PL-1016K7-23-2		-16 (ODT)		HHBP-16
	25		PL-1016K7-25-2		-20 (ODT)		HHBP-20
	27		PL-1016K7-27-2		-24 (ODT)		HHBP-24
11	Gear Sets (Versatile)	1		20	Seal Retainer (with O.B. Bearing)	1	PL-1003
	7/8-13T Spline			21	Seal Snap Ring	1 or 2	PL-1004
	14		PL-1016S-14-2TV	22	Dowell Pin	4	PL-1024
	16		PL-1016S-16-2TV	23	Connection Shaft	1	PL-1033TV
	19		PL-1016S-19-2TV	25	Rear Flange Gasket	1	PL1032TV
	23		PL-1016S-23-2TV	N.S.	Relief Valve Cartridge	1	1224V-1
	1 In. Round				Seal & O-Ring Kit		GSKPL-2
	14		PL-1016K-14-2TV		Rebuild Kit		RBKPL-2
	16		PL-1016K-16-2TV		Bearing Kit		PL-1013-K
	19		PL-1016K-19-2TV				
	23		PL-1016K-23-2TV				
12	Body Seal Front Cover	1	PL-1012				